

# Technical data sheet

## Product features



### Cooking range solid top gas on open cabinet

|              |                 |          |
|--------------|-----------------|----------|
| <b>Model</b> | <b>SAP Code</b> | 00019431 |
|--------------|-----------------|----------|



- Device type: Gas unit
- Power consumption of the zone 1 [kW]: 10,8
- Ignition: Piezo + Eternal Flame
- Material: AISI 304 top plate and cladding

|                        |          |   |                                |
|------------------------|----------|---|--------------------------------|
| <b>SAP Code</b>        | 00019431 | <b>Power gas [kW]</b>                       | 10.800                         |
| <b>Net Width [mm]</b>  | 800      | <b>Type of gas</b>                          | Natural gas,<br>propane butane |
| <b>Net Depth [mm]</b>  | 730      | <b>Number of zones</b>                      | 1                              |
| <b>Net Height [mm]</b> | 900      | <b>Power consumption of the zone 1 [kW]</b> | 10,8                           |
| <b>Net Weight [kg]</b> | 99.00    | <b>Solid top dimensions [mm x mm]</b>       | 800 x 580                      |

# Technical data sheet

Technical drawing



Cooking range solid top gas on open cabinet

Model

SAP Code

00019431

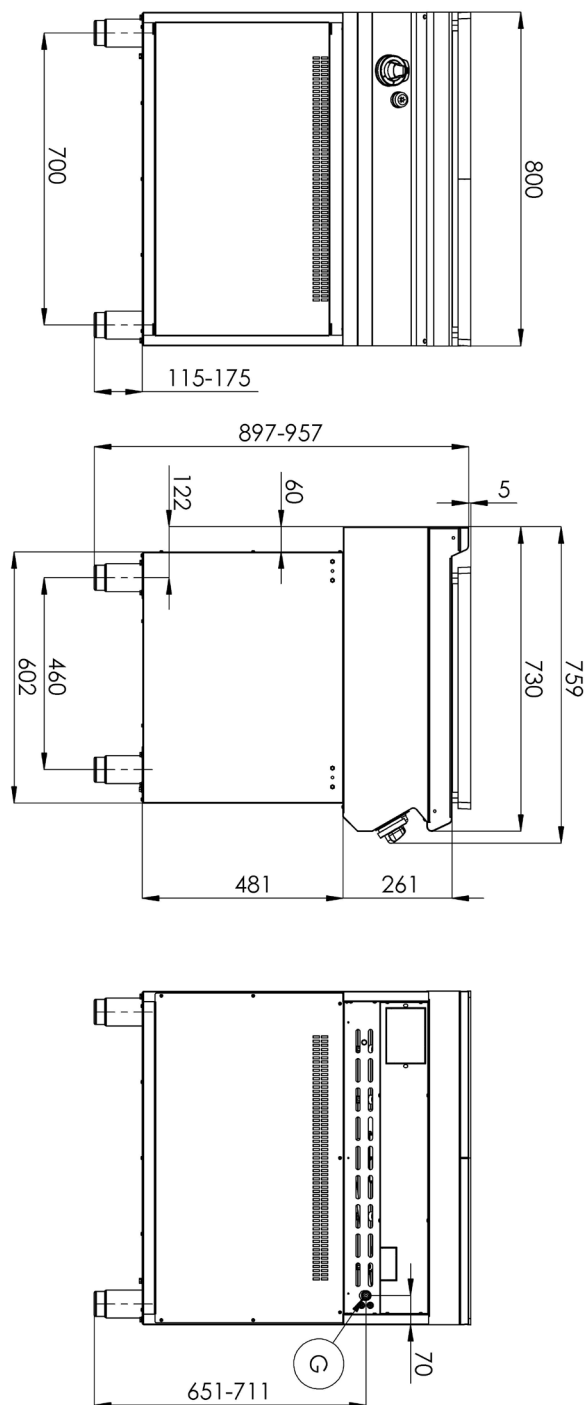

# Technical data sheet

## Technical parameters



### Cooking range solid top gas on open cabinet

**Model**

**SAP Code**

00019431

**1. SAP Code:**

00019431

**2. Net Width [mm]:**

800

**3. Net Depth [mm]:**

730

**4. Net Height [mm]:**

900

**5. Net Weight [kg]:**

99.00

**6. Gross Width [mm]:**

860

**7. Gross depth [mm]:**

800

**8. Gross Height [mm]:**

1065

**9. Gross Weight [kg]:**

113.00

**10. Device type:**

Gas unit

**11. Construction type of device:**

With substructure

**12. Power gas [kW]:**

10.800

**13. Ignition:**

Piezo + Eternal Flame

**14. Type of gas:**

Natural gas, propane butane

**15. Exterior color of the device:**

Stainless steel

**16. Material:**

AISI 304 top plate and cladding

**17. Worktop type:**

Molded - comfortable cleaning maintenance

**18. Worktop material:**

AISI 304

**19. Worktop Thickness [mm]:**

1.50

**20. Number of zones:**

1

**21. Power consumption of the zone 1 [kW]:**

10,8

**22. Service accessibility:**

Trough the frontal panel

**23. Safety thermocouple:**

Yes

**24. Adjustable feet:**

Yes

**25. Number of burners/hot plates:**

1

**26. Type of gas cooking zones:**

Thales

**27. Solid top thickness [mm]:**

30

**28. Solid top dimensions [mm x mm]:**

800 x 580

# Technical data sheet

Technical parameters



## Cooking range solid top gas on open cabinet

|              |                 |          |
|--------------|-----------------|----------|
| <b>Model</b> | <b>SAP Code</b> | 00019431 |
|--------------|-----------------|----------|

### 29. Solid top ignition:

Piezo + Eternal Flame

### 30. Connection to a ball valve:

1/2